

# VENTÜER TECHNICAL DATA SHEET

The Ventüer VL-55S louvre system is a slim single bank ventilation louvre ideal for small grilles, exhaust vents, louvred doors and mechanical screening. It comes with flanged and channel frame options, and can be fitted with bird mesh, insect mesh or dust filters.

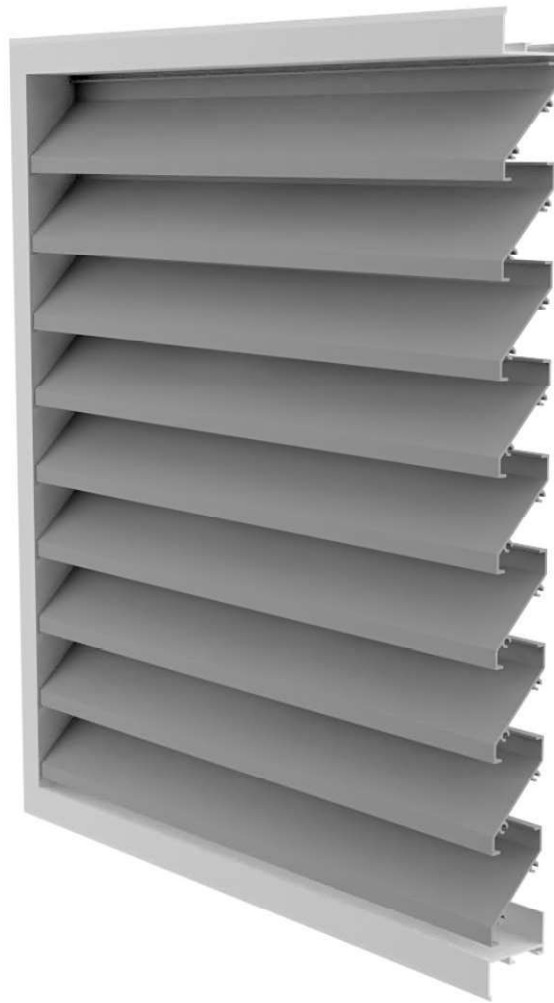

The tables below represent the VL-55S performance results for water ingress and pressure drop when tested to BS/EN:13030. For more information and the Ventüer louvre calculator please visit [www.ventuer.co.nz](http://www.ventuer.co.nz).

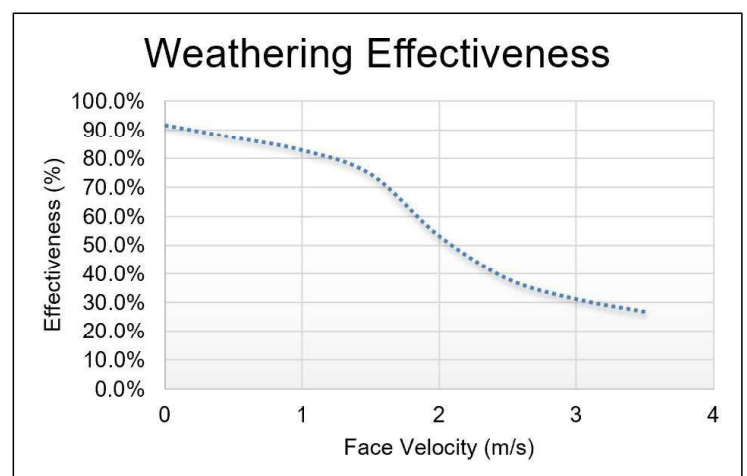
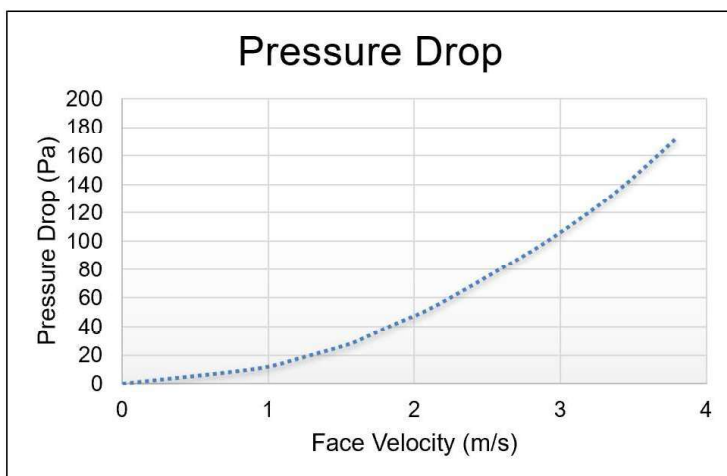

**VENTILATION LOUVRE**  
**VL-55S**



**VENTÜER**  
High-Performance Building Ventilation

P: +64 9 973 3616  
W: [ventuer.co.nz](http://ventuer.co.nz)  
© 2019 All rights reserved

Scale: NTS  
Date: 19/03/2019

VL-55S Ver.1

# VENTÜER TECHNICAL DATA SHEET

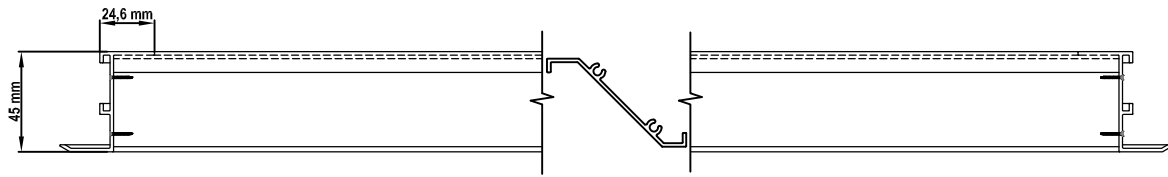

FLANGED FRAME - HORIZONTAL SECTION

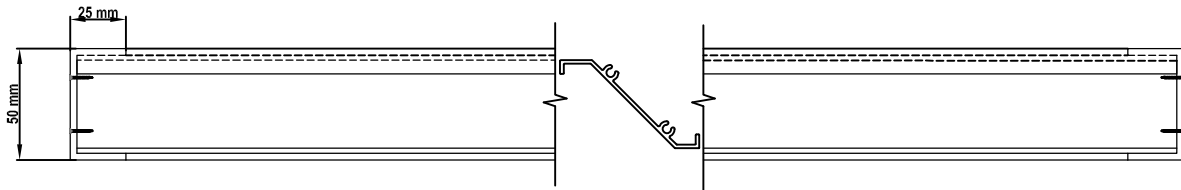

CHANNEL FRAME - HORIZONTAL SECTION

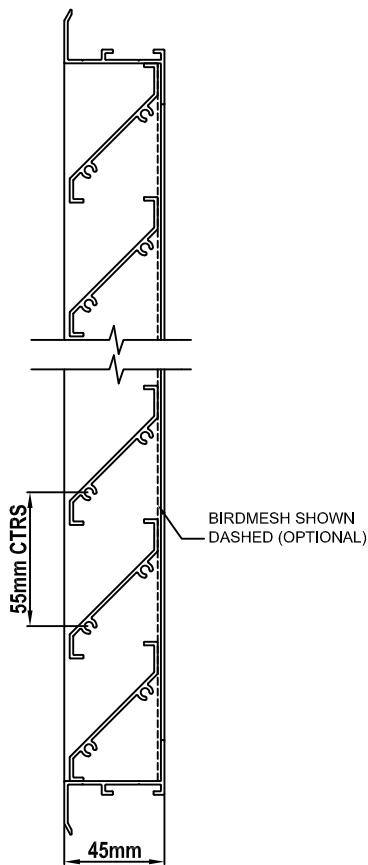

FLANGED FRAME  
VERTICAL SECTION

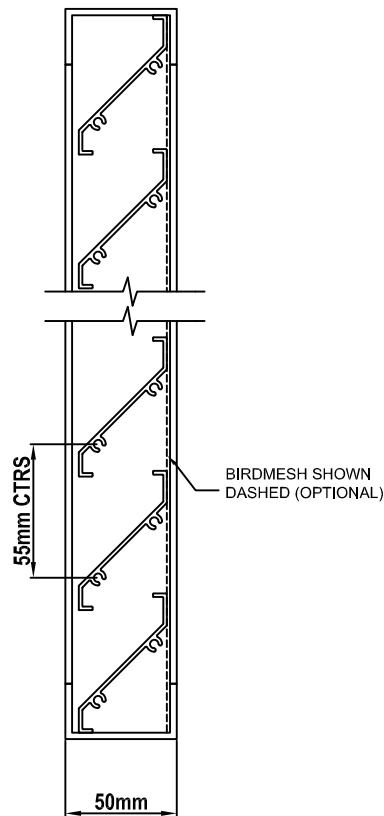

CHANNEL FRAME  
VERTICAL SECTION

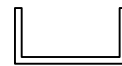

VL-55S CHANNEL FRAME

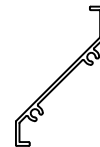

VL-55S LOUVRE BLADE

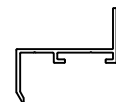

VL-55S FLANGED FRAME

**Free Area Percentage:**  
42% of Active Louvre Area

VENTILATION LOUVRE  
VL-55S



**VENTÜER**  
High-Performance Building Ventilation

P: +64 9 973 3616  
W: ventuer.co.nz  
© 2019 All rights reserved

Scale: NTS  
Date: 19/03/2019

VL-55S Ver.1